

STUDIO TIP SogA

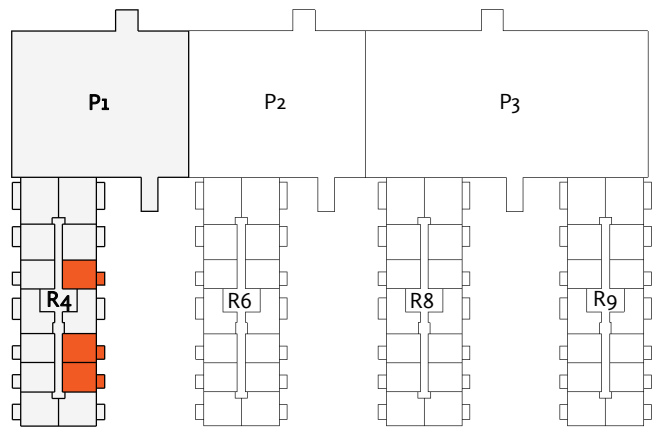

SUPRAFETE UTILE

1	CAMERA DE ZI + LOC DE LUAT MASA + BUCATARIE	31.2 m ²
2	BAIE	4.5 m ²
3	HOL	4.1 m ²
4	HOL	2.2 m ²
TOTAL SUPRAFATA UTILA		41.9 m ²
5	BALCON	5.7 m ²

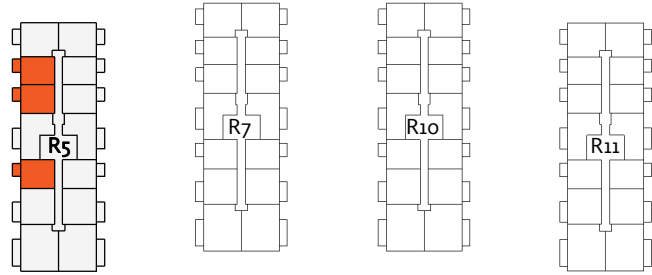
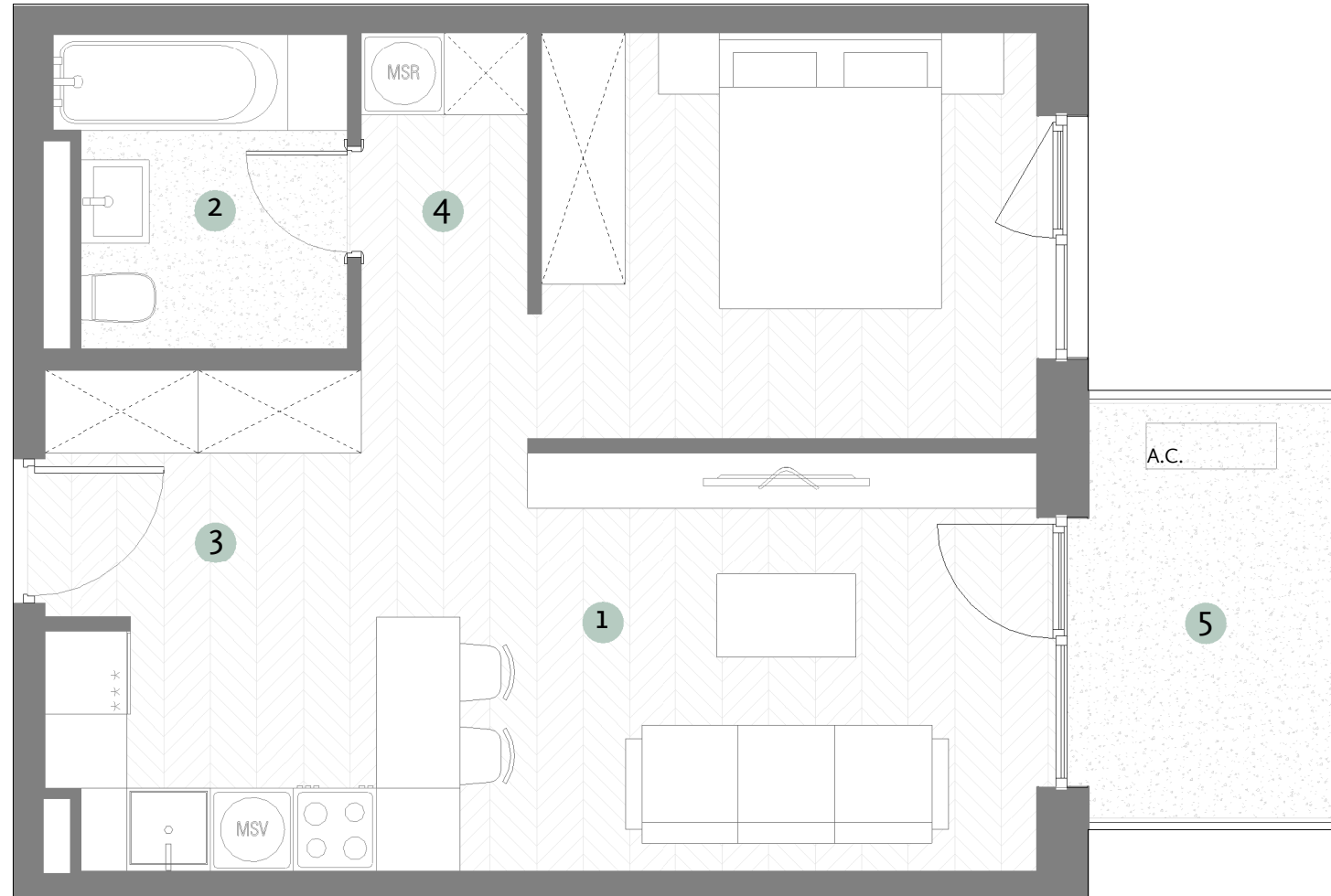

NR. CAMERE APARTAMENT	CLADIRE	NIVEL	DENUMIRE	SUPRAFATA CONSTRUITA	TIP APARTAMENT
1	R4 - R5	ET 01 - 11	LOCUINTA	48.3 m ²	S09A
1	R4 - R5	ET 01 - 11	BALCON	6.0 m ²	S09A
TOTAL SUPRAFETE CONSTRUITE				54.2 m ²	