

## APARTAMENT 2 CAMERE TIP 2R13A

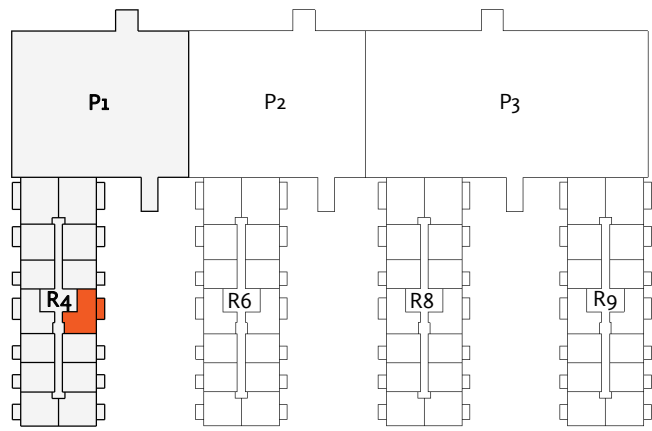

### SUPRAFETE UTILE

1	CAMERA DE ZI + LOC DE LUAT MASA	20.7 m <sup>2</sup>
2	DORMITOR	13.9 m <sup>2</sup>
3	BUCATARIE	6.2 m <sup>2</sup>
4	HOL	5.5 m <sup>2</sup>
5	BAIE	4.7 m <sup>2</sup>
6	HOL	2.8 m <sup>2</sup>
TOTAL SUPRAFATA UTILA		53.8 m <sup>2</sup>
7	BALCON	8.8 m <sup>2</sup>

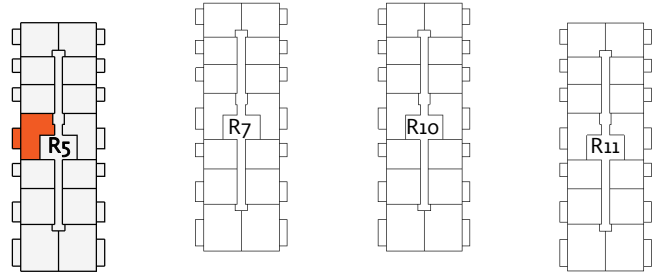
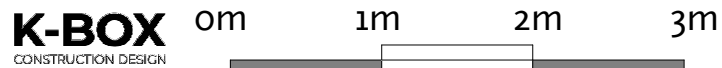
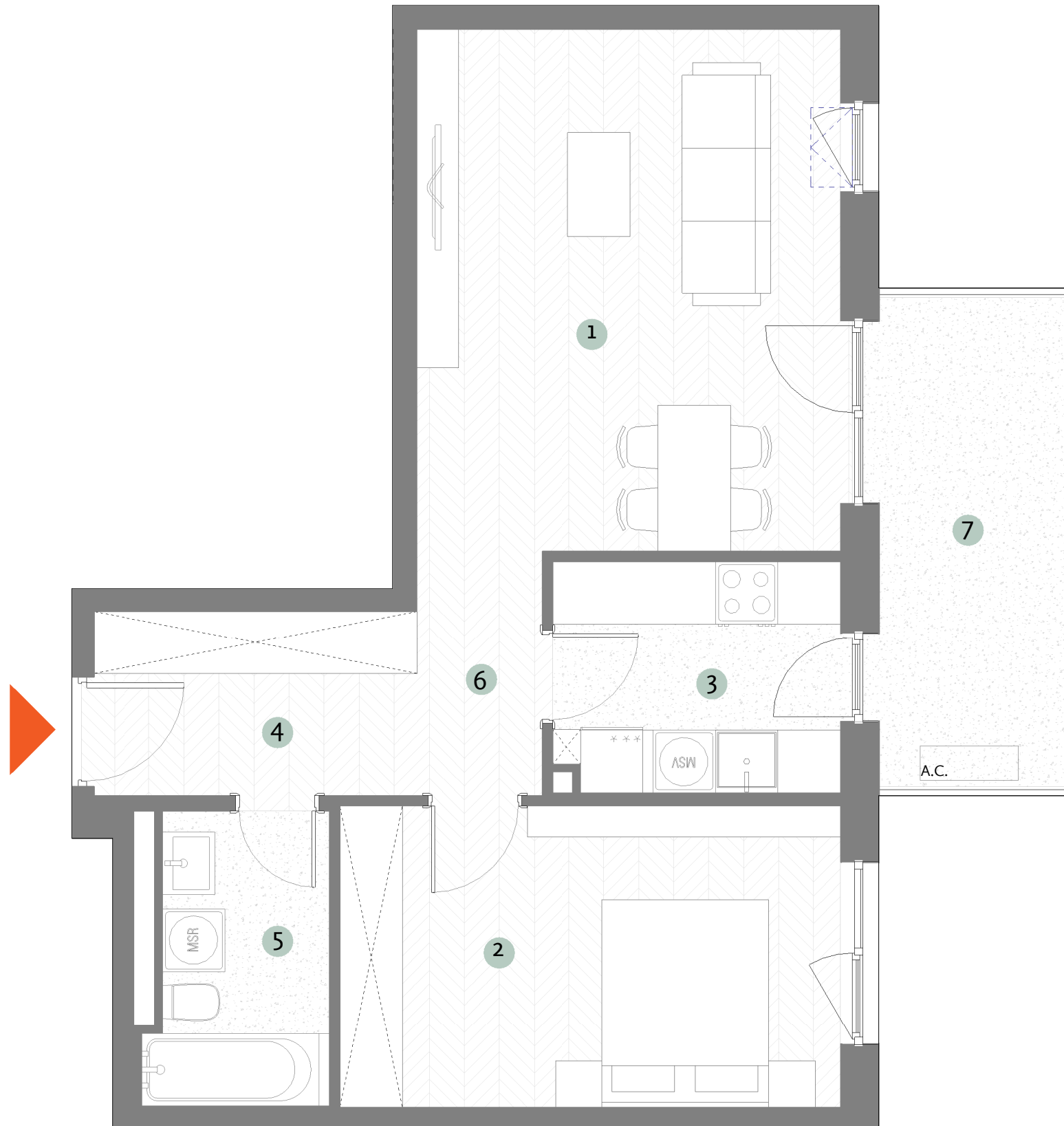

NR. CAMERE APARTAMENT	CLADIRE	NIVEL	DENUMIRE	SUPRAFATA CONSTRUITA	TIP APARTAMENT
2	R4 - R5	ET 01 - 11	LOCUINTA	62.7 m <sup>2</sup>	2R13A
2	R4 - R5	ET 01 - 11	BALCON	9.2 m <sup>2</sup>	2R13A
TOTAL SUPRAFETE CONSTRUITE				71.9 m <sup>2</sup>	

*Prezentul material de prezentare are caracter informativ si poate suferi modificari rezonabile.  
Prezentarea si pozitionarea mobilierului si electrocasnicelor sunt in scop orientativ si nu creeaza obligatii in sarcina vanzatorului.*