

APARTAMENT 2 CAMERE TIP 2R15A

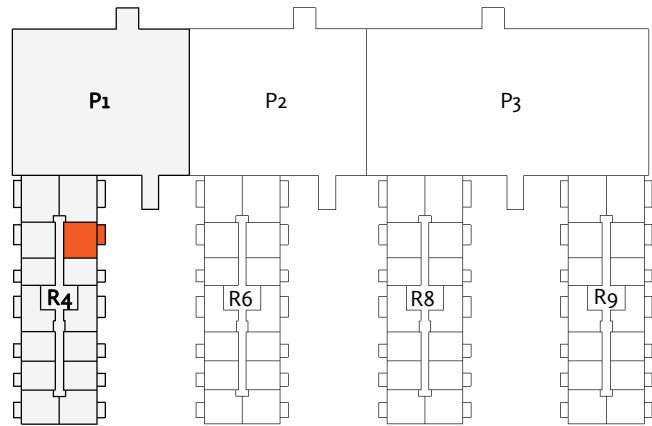

SUPRAFETE UTILE

1	CAMERA DE ZI	18.3 m ²
2	DORMITOR	13.0 m ²
3	BUCATARIE	6.9 m ²
4	BAIE	4.6 m ²
5	HOL	3.6 m ²
6	LOC DE LUAT MASA	3.5 m ²
7	HOL	2.9 m ²
TOTAL SUPRAFATA UTILA		52.7 m ²
8	BALCON	8.5 m ²

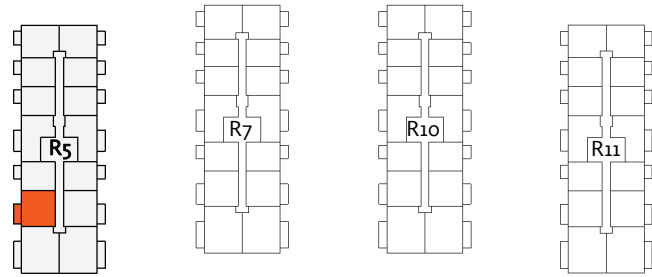

NR. CAMERE APARTAMENT	CLADIRE	NIVEL	DENUMIRE	SUPRAFATA CONSTRUITA	TIP APARTAMENT
2	R4 - R5	ET 01 - 10	LOCUINTA	60.5 m ²	2R15A
2	R4 - R5	ET 01 - 10	BALCON	8.8 m ²	2R15A
TOTAL SUPRAFETE CONSTRUISTE				69.3 m ²	